

MTU_ValueService

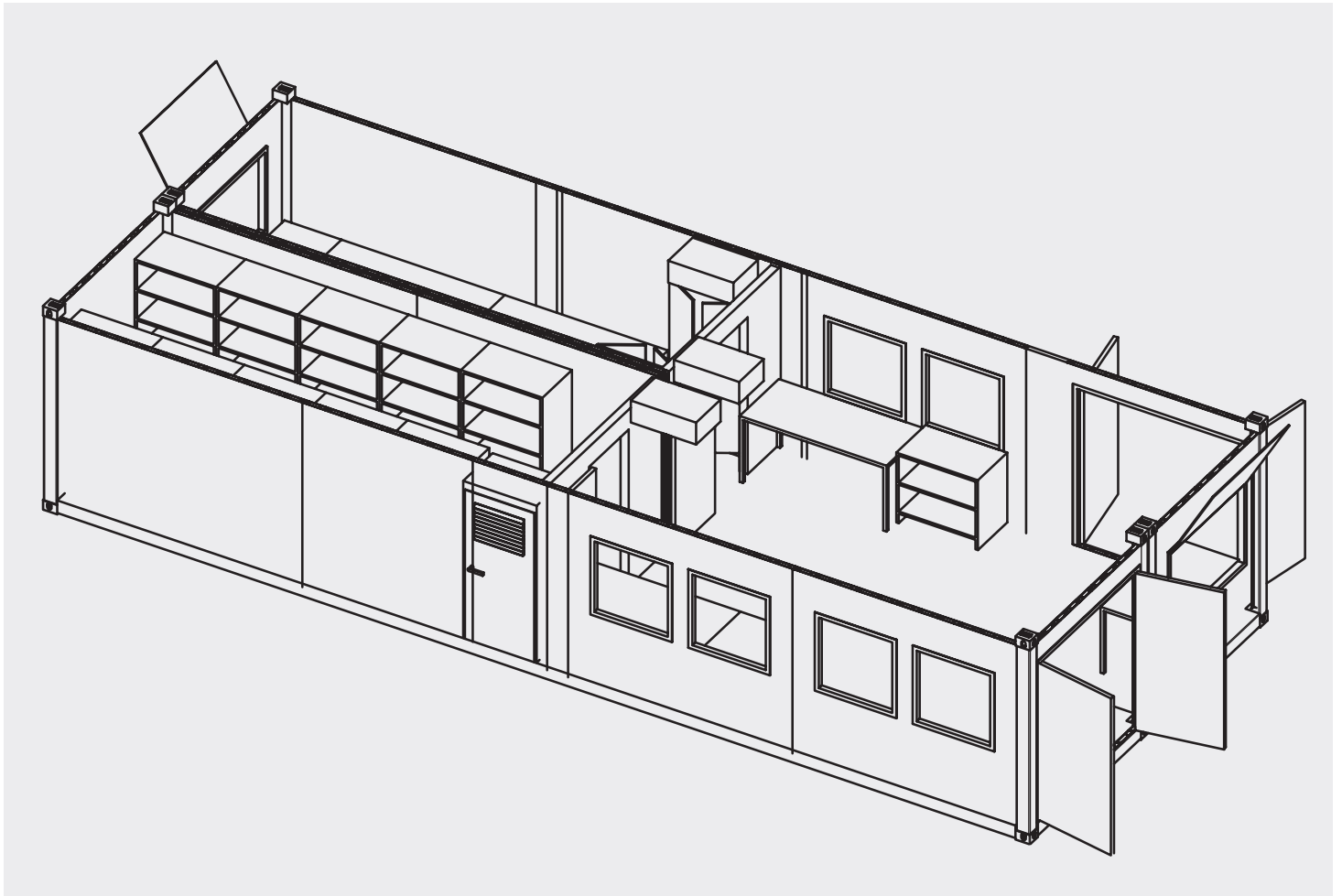

MTU Service Unit

Workshop, Storage Facility
and Office – Integrated in
One Unit.



Unlimited Customer Support

MTU sets the standard for comprehensive product and customer support. We offer worldwide assistance and service – you can always reach us from anywhere. And if you can't come to us, we'll come to you. If you have your engine or system in a remote location, we offer transportable MTU Service Units. Integrating workshop, storage and office facilities, an MTU Service Unit can be set up in virtually any location, to ensure optimal maintenance and service intervals. You get confidence and peace of mind for any project, at any worksite.

Gain Much-Needed Space to

- Accommodate suitable facilities for service work
- Store spare parts and auxiliaries
- Carry out administrative tasks

Benefits

- Turnkey solution
- Immediate availability
- High mobility
- A minimum of interfaces with the local infrastructure (access, power supply)
- Visible on-site presence

Product Description

The MTU Service Unit is a combination of two independent units. Exterior dimensions and transport elements are similar to a standard 40' high cube container. The units offer headroom of 2.5m, are easily transported and can be set up either individually or in combination.

Equipment

The MTU Service Unit's equipment includes: air-conditioning system, diesel genset, hydraulic press, air compressor, drilling/milling machine, workbenches, fold-down table-tops, heavy-duty shelving, desks and filing cabinets.

Auxiliary Equipment

A comprehensive range of auxiliary equipment is available such as access ramps, chain hoists, lifting devices, storm and sand protection. Depending on customer requirements and local conditions, auxiliary equipment can be complemented, reduced or adapted with appropriate accessories.

Basic Construction

All basic design supports and frames consist of galvanized steel elements for high durability. The insulated non-profile PU sandwich construction walls maximize internal space. This construction differs significantly from standard containers.

Further Questions

For more information, please email us at workshop.testbench@mtu-online.com

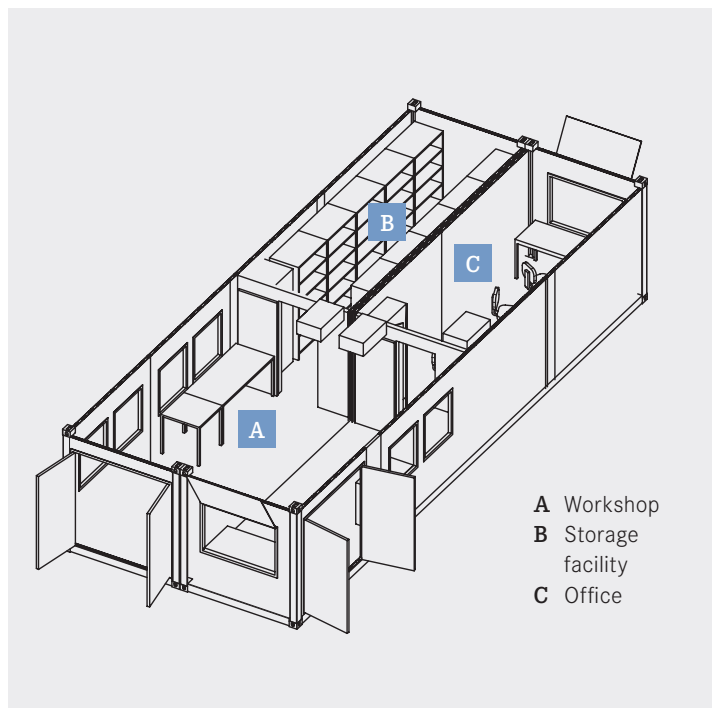

Internal Dimensions / Footprint

		Lenght	Width	Height	Footprint
		m	m	m	m ²
Workshop	(A)	5,90	4,70	2,50	27
Storage facility	(B)	5,90	2,20	2,50	13
Office	(C)	5,90	2,20	2,50	13